

P-01-01

EVERGREEN RIDGE P.U.D. - PHASE 1, DIVISION 3
 A PORTION OF THE NORTHWEST 1/4 OF SECTION 12, T. 20N., R. 14E., W.M.
 KITTITAS COUNTY, STATE OF WASHINGTON

LINE BEARING	LENGTH	CURVE TABLE	DELTA
L1	N01°11'40"W	91.30'	91.30'
L2	N01°11'40"W	91.30'	91.30'
L3	N40°32'28"W	78.03'	78.03'
L4	N13°43'07"W	35.66'	35.66'
L5	N13°43'07"W	50.30'	50.30'
L6	N01°36'17"W	92.61'	92.61'
L7	N01°36'17"W	15.88'	15.88'
L8	N01°36'17"W	36.07'	36.07'
L9	N01°36'17"W	36.07'	36.07'
L10	N44°31'08"W	54.84'	54.84'
L11	N44°31'08"W	54.84'	54.84'
L12	N10°42'54"E	36.93'	36.93'
L13	N40°32'28"W	48.99'	48.99'
L14	N13°43'07"W	35.66'	35.66'
L15	N13°43'07"W	35.66'	35.66'
L16	N01°36'17"W	74.17'	74.17'
L17	N01°36'17"W	6.29'	6.29'
L18	S89°18'01"E	50.31'	50.31'
L19	S89°18'01"E	64.11'	64.11'
L20	S43°17'00"E	47.01'	47.01'
L21	S43°17'00"E	31.09'	31.09'

CURVE	LENGTH	RADIUS	DELTA
C1	92.88'	200.00'	151.923°
C2	47.75'	200.00'	134.623°
C3	32.21'	150.00'	121.613°
C4	21.34'	150.00'	89.907°
C5	31.74'	150.00'	103.301°
C6	38.00'	500.00'	121.744°
C7	30.30'	100.00'	172.144°
C8	18.07'	500.00'	211.300°
C9	30.25'	500.00'	327.59°
C10	14.63'	250.00'	321.50°
C11	16.94'	250.00'	103.11°
C12	16.94'	250.00'	103.11°
C13	68.39'	250.00'	117.753°
C14	68.39'	250.00'	117.753°
C15	65.71'	150.00'	230.007°
C16	4.42'	150.00'	131.702°
C17	44.68'	500.00'	330.34°
C18	28.35'	500.00'	330.34°
C19	4.33'	500.00'	337.01°
C20	243.04'	250.00'	534.007°



RECEIVED
 JAN 06 2021
 Kittitas Co. CDS



RECORDER'S CERTIFICATE
 Filed for record this 18th day of March 2008 at 10:11 AM
 in book II of PLATS at page 153 at the request of
 DAVID P. NELSON
 County Auditor

SURVEYOR'S CERTIFICATE
 This map correctly represents a survey made by me or under my direction in conformance with the requirements of the Survey Recording Act of the State of Washington.
 DAVID P. NELSON
 Certificate No. 18092

Enccompass
 ENGINEERING & SURVEYING
 108 EAST 2ND STREET
 CLE ELUM, WA 99022
 PHONE: (509) 874-7433
 FAX: (509) 874-7418

EVERGREEN RIDGE P.U.D. - PHASE 1, DIVISION 3
 A PORTION OF THE NW 1/4 OF SECTION 12, T. 20N., R. 14E., W.M.
 KITTITAS COUNTY, STATE OF WASHINGTON

DWN BY: G. WEISER
 CHKD BY: D. NELSON

DATE: 05/08
 SCALE: 1"=100'

JOB NO.: 07234
 SHEET: 1 OF 2

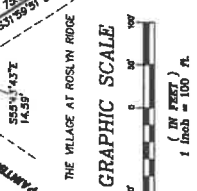

- LEGEND**
- SECTION CORNER AS NOTED
 - QUARTER CORNER AS NOTED
 - SET REBAR & CAP LSH 18092
 - FOUND REBAR & CAP

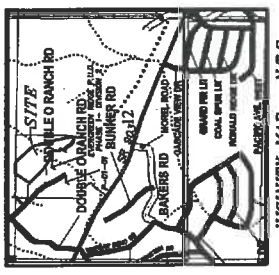

APPROVALS
 KITTITAS COUNTY DEPARTMENT OF PUBLIC WORKS
 EXAMINED AND APPROVED THIS 17th DAY OF JUNE A.D., 2008

KITTITAS COUNTY HEALTH DEPARTMENT
 I HEREBY CERTIFY THAT THE EVERGREEN RIDGE P.U.D. PHASE 1, DIVISION NO. 3 PLAT HAS BEEN EXAMINED BY ME AND I FIND THAT THE SEWERAGE AND WATER SYSTEM HEREIN SHOWN DOES MEET AND COMPLY WITH ALL REQUIREMENTS OF THE COUNTY HEALTH DEPARTMENT.
 DATED THIS 9th DAY OF JUNE A.D., 2008

KITTITAS COUNTY PLANNING DIRECTOR
 I HEREBY CERTIFY THAT THE EVERGREEN RIDGE P.U.D. PHASE 1, DIVISION NO. 3 PLAT HAS BEEN EXAMINED BY ME AND I FIND THAT IT CONFORMS TO THE COMPREHENSIVE PLAN OF THE KITTITAS COUNTY PLANNING COMMISSION.
 DATED THIS 10th DAY OF JUNE A.D., 2008

KITTITAS COUNTY TREASURER
 I HEREBY CERTIFY THAT THE FEES AND ASSESSMENTS ARE PAID FOR THE PRECEDING YEARS AND FOR THIS YEAR IN WHICH THE PLAT IS NOW TO BE FILED.
 PARCEL NOS.: PTL 20-14-12022-0008 (792534) & 20-14-01030-0020 (12065)
 DATED THIS 5th DAY OF JUNE A.D., 2008

KITTITAS COUNTY ASSESSOR
 I HEREBY CERTIFY THAT THE EVERGREEN RIDGE P.U.D. PHASE 1, DIVISION NO. 3 PLAT HAS BEEN EXAMINED BY ME AND I FIND THAT IT CONFORMS TO THE COMPREHENSIVE PLAN OF THE KITTITAS COUNTY PLANNING COMMISSION.
 PARCEL NOS.: PTL 20-14-12022-0008 (792534) & 20-14-01030-0020 (12065)
 DATED THIS 5th DAY OF JUNE A.D., 2008

KITTITAS COUNTY BOARD OF COMMISSIONERS
 EXAMINED AND APPROVED THIS 17th DAY OF JUNE A.D., 2008

BOARD OF COUNTY COMMISSIONERS
 KITTITAS COUNTY, WASHINGTON
 BY: [Signature]
 CHAIRMAN-VICE

NOTICE: THE APPROVAL OF THIS PLAT IS NOT A GUARANTEE THAT FUTURE PERMITS WILL BE GRANTED.

11-151

RECT 06/15/2008 01:17:46 PM V: 11 P: 154 200809180913
KITTITAS COUNTY, WASHINGTON
KITTITAS COUNTY, WASHINGTON

EVERGREEN RIDGE P.U.D. - PHASE 1, DIVISION 3 A PORTION OF THE NORTHWEST 1/4 OF SECTION 12, T. 20N., R. 14E., W.M. KITTITAS COUNTY, STATE OF WASHINGTON

OWNER:
TEAMAWAY RIDGE LLC
PO BOX 808
CLE ELUM, WA 98922

PARCEL # PTV 20-14-181022-0008 (792534) &
20-1030-0008 (18046)
ACREAGE TOTAL FOR PARCEL 792534 IS 66.74 ACRES &
TOTAL FOR PARCEL 12065 IS 38.82 ACRES
ACREAGE FOR PHASE 1, DIVISION 3 IS 11.30 ACRES
LOTS: 22

WATER SOURCE EVERGREEN VALLEY GROUP A
SEWER SOURCE EVERGREEN RIDGE P.U.D.-PHASE 1, DIVISION 3 WILL BE
SUPPLIED SEWER SERVICE ACCORDING TO FILE Z-06-33.
ZONE: PLANNED UNIT DEVELOPMENT

EASEMENT PROVISIONS:

AN EASEMENT IS HEREBY GRANTED TO, AND RESERVED FOR PUGET SOUND ENERGY COMPANY, EVERGREEN VALLEY WATER SYSTEMS, INC., ROSLIN TELEPHONE COMPANY, AND EVERGREEN VALLEY WATER SYSTEMS, INC. AND ASSONS UNDER AND UPON LOTS IN WHICH TEN FEET WIDE EASEMENTS ARE SHOWN TO BE NECESSARY TO INSTALL, MAINTAIN, OPERATE AND MAINTAIN UNDERGROUND CONDUITS, CABLES AND WIRES WITH NECESSARY FACILITIES AND OTHER EQUIPMENT FOR THE PURPOSE OF SERVING THIS SUBDIVISION AND OTHER PROPERTY WITH ELECTRIC, NATURAL GAS, TELEPHONE, AND WATER SERVICE, TOGETHER WITH THE RIGHT TO ENTER UPON THE LOTS AT ALL TIMES FOR THE PURPOSE HEREIN STATED. THESE EASEMENTS ENTERED UPON FOR THESE PURPOSES SHALL BE RESTORED AS NEAR AS POSSIBLE TO THEIR ORIGINAL CONDITION.

NOTE:

THE EXISTING UTILITIES AS SHOWN ARE ONLY APPROXIMATE AND ARE BASED ON THE BEST AVAILABLE INFORMATION. IT SHALL BE THE CONTRACTOR'S RESPONSIBILITY TO VERIFY THE SIZE, TYPE, LOCATION AND DEPTH OF ALL EXISTING UTILITIES PRIOR TO ANY CONSTRUCTION AND THROUGH THE DESIGN ENGINEER OF ANY DISCREPANCIES.

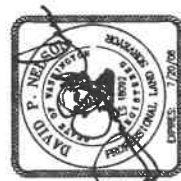

Call Before You Dig
1-800-553-4344

DEDICATION

KNOW ALL MEN BY THESE PRESENTS THAT TEAMAWAY RIDGE, LLC, A WASHINGTON LIMITED LIABILITY COMPANY, THE UNDERSIGNED OWNER IN FEE SIMPLE OF THE HEREIN DESCRIBED REAL PROPERTY, DOES HEREBY DECLARE, SUBMIT AND PLAY AS HEREIN DESCRIBED.

IN WITNESS WHEREOF, WE HAVE SET OUR HANDS THIS 5th DAY OF June, A.D. 2008

NAME: David J. Nelson
TITLE: Professional Engineer

ACKNOWLEDGEMENT
STATE OF WASHINGTON)
COUNTY OF KITTITAS)

On this 5th day of June, 2008, before me, the undersigned, a Notary Public for the State of Washington, duly commissioned and sworn to, and qualified to perform the duties of my office, the following persons, to me known to be the persons whose names are subscribed to the foregoing instrument, and acknowledged the said instrument, that they executed the same for the purposes and consideration therein expressed, and on oath stated that they were authorized to execute the said instrument.

Witness my hand and official seal hereto affixed the day and year first above written.

David J. Nelson
Notary Public for the State of Washington, residing at _____
by appointment expires _____



ADJACENT PROPERTY OWNERS:

- 792534 21824 BOULDER CREEK DEV CO INC PO BOX 808 CLE ELUM WA 98922
- 582534 12065 BOULDER CREEK DEV CO INC PO BOX 808 CLE ELUM WA 98922
- 582534 12065 BOULDER CREEK DEV CO INC PO BOX 808 CLE ELUM WA 98922
- 12064 PLUM CREEK TIMBER CO LP PO BOX 1990 COLUMBIA FALLS MT 59912

21816 LARS I LANDRIE ETUX 16821 S LANDRIE ETUX BELLEVUE WA 98004

21818 MARK BRAKVEN ETUX 21818 WILSON DR NW CGG HARBOR WA 98335

21819 STEVE MEHL ETUX 203 TIGER LILY LANE RONALD WA 98940

21820 LARRY & FAIRIE SILVA 3132 MOOSE CANYON RD COUER D'ALENE ID 83814

21821 DAVID HATLEN ETUX 23 W NEWELL SEATTLE WA 98119

21822 B DOREMIUS ETAL 6847 COAL CREEK PARKWAY SE NEWCASTLE WA 98055

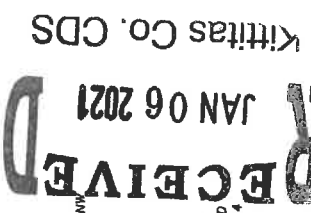

RECORDER'S CERTIFICATE 200809180913

Filed for record this 5th day of June, 2008 at 1:17 PM in book 4000, page 151, at the request of DAVID J. NELSON, Surveyor at large, Kittitas County Auditor

SURVEYOR'S CERTIFICATE

This map correctly represents a survey made by me or under my direction in conformance with the requirements of the Survey Recording Act at the request of TEAMAWAY RIDGE, LLC, a Washington Limited Liability Company, and I certify that the same is correct and true to the best of my knowledge and belief.

DAVID P. NELSON
COUNTY AUDITOR
Certificate No. 18092



ENGINEERING & SURVEYING
108 EAST 4TH STREET
CLE ELUM, WA 98922
PHONE: (509) 874-7433
FAX: (509) 874-7419

EVERGREEN RIDGE P.U.D. - PHASE 1, DIVISION 3 A PTL OF THE NW 1/4 OF SECTION 12, T. 20N., R. 14E., W.M. KITTITAS COUNTY, STATE OF WASHINGTON	
DWN BY	DATE
G. WEISER	05/08
CHECK BY	SCALE
D. NELSON	1"=100'
JOB NO.	SHEET
07234	2 of 2